



THE MOBILE RIPPLES CLOUD!

Ripples Customer Success



THE MOBILE RIPPLES CLOUD

An easier way to control your designs on your Ripple Maker.

- Create new designs
- Delete old ones
- Add new frames
- Publish new Channels
- Discover new designs in the Ripples library
- Download your Ripples Web App QR Code & Link



LET'S GET STARTED!

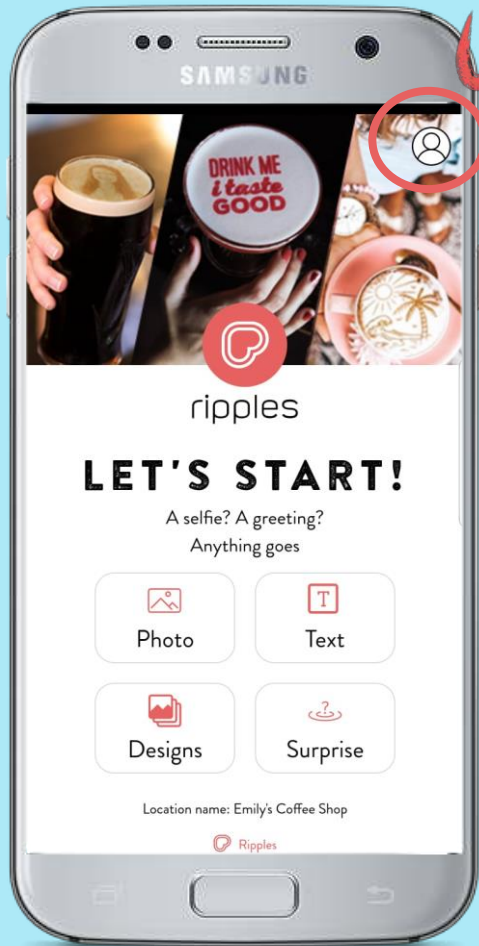

- Scan your Ripples Web App QR Code
- Download the printable QR code [here](#)
- Tap the User icon in the top right corner
- Use your existing user to login
- Reset your password if you forgot it
- Or create a new account if you don't have one (please note you need to be beside your Ripple Maker create a new account)
- Also login through Custom Web Apps

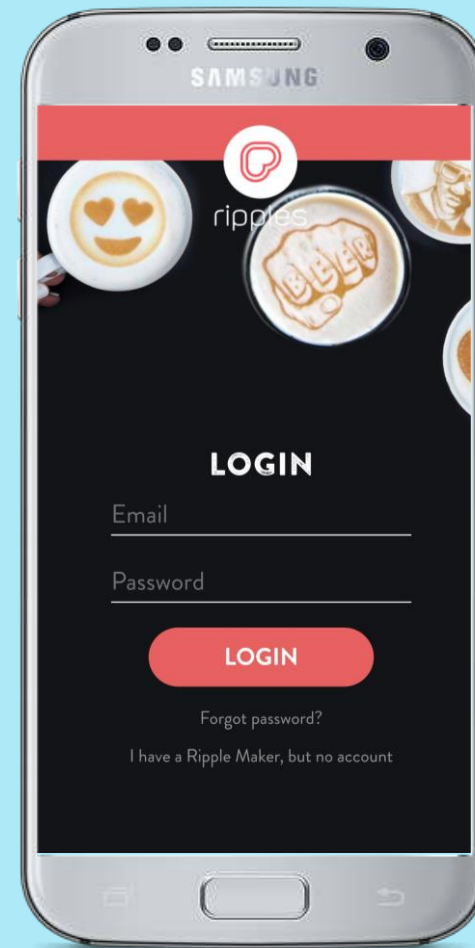

IN APP FLOWS

In the main menu you will have 6 different actions you can complete

1. Create
2. Delete
3. Publish
4. Frames
5. Channels
6. QR Code

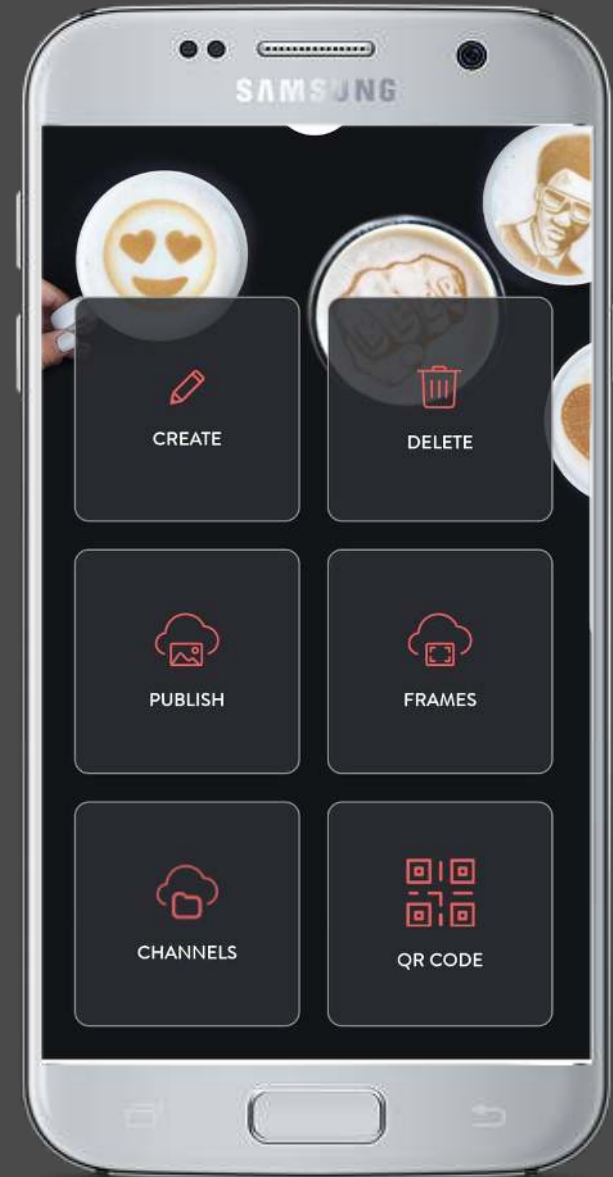

CREATE

This feature allows you to upload custom text, images or designs.

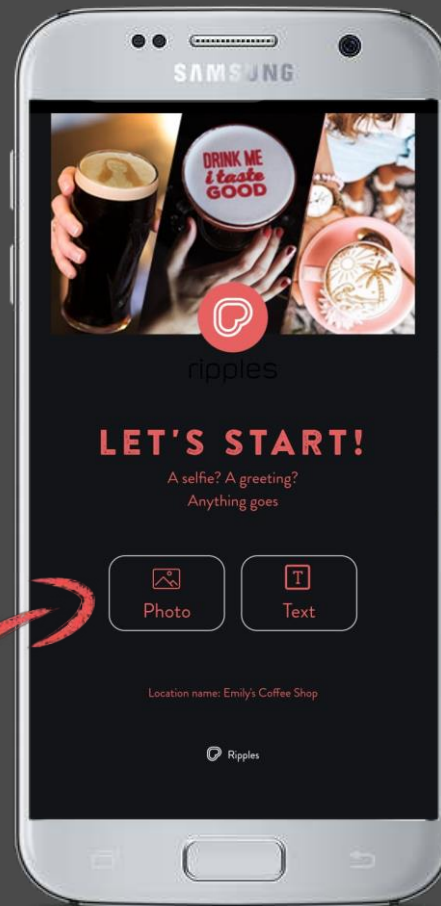
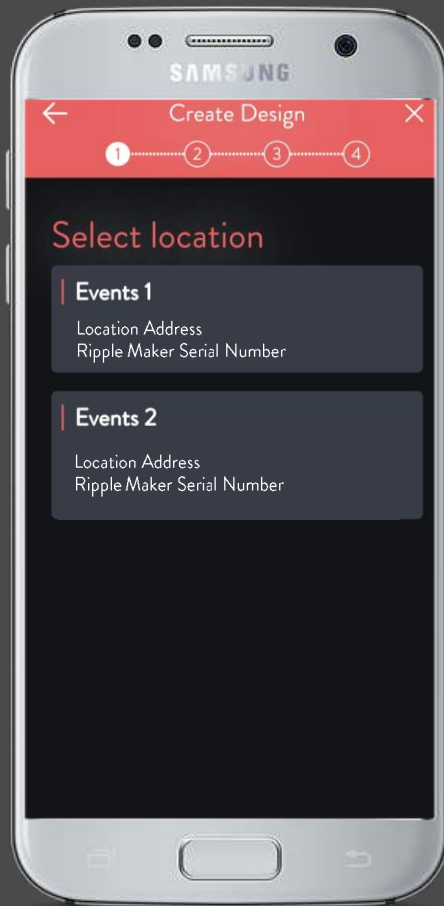

1. If you have more than one location choose which location to edit.
2. Photo- to take a photo, or choose from your gallery.
Text- create a custom text design.

3. Pinch to zoom and adjust the image.
4. Select a filter that increases the image contrast.

CREATE

This feature allows you to upload custom text, images or designs.

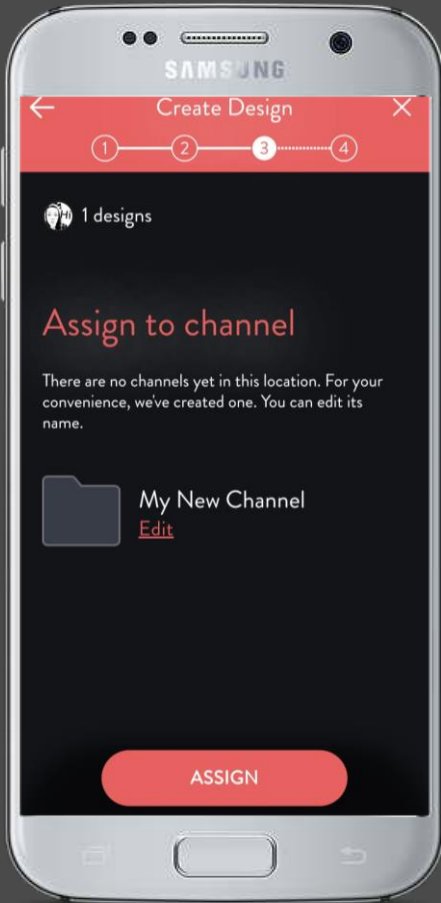

The first time uploading a design to your Ripple Maker you will be asked to make a new Custom Channel. Tap "ASSIGN"

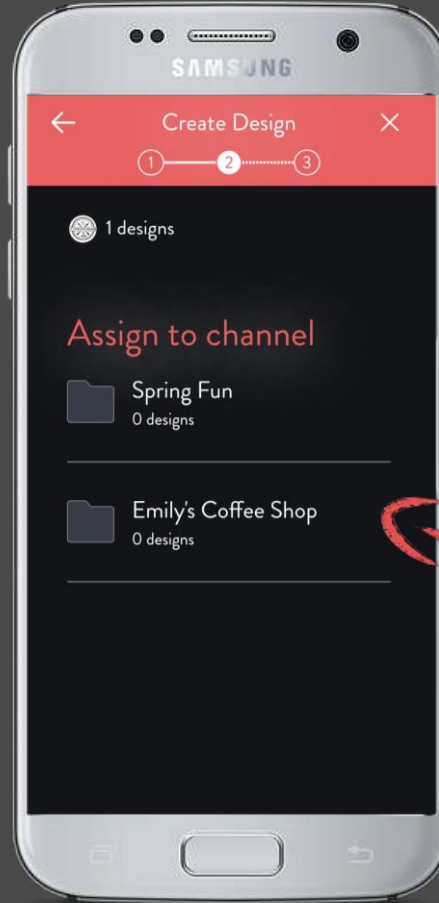

If you already have channels at this location select which channel you want to publish the design too.

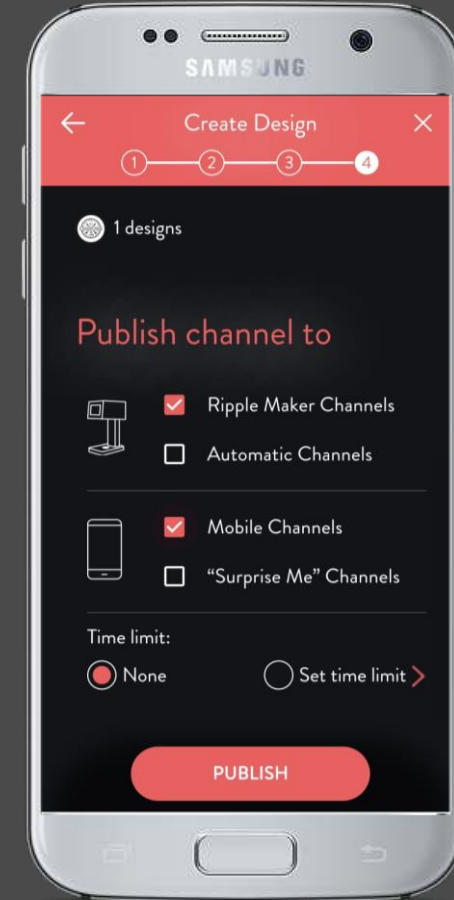

Choose to publish the channel on Ripple Maker or Mobile App, select a time limit & "PUBLISH"

CREATE

Tips for choosing filters & creating the best designs.



This filter is not good for this photo. It is too light, washed out, and has no definition.

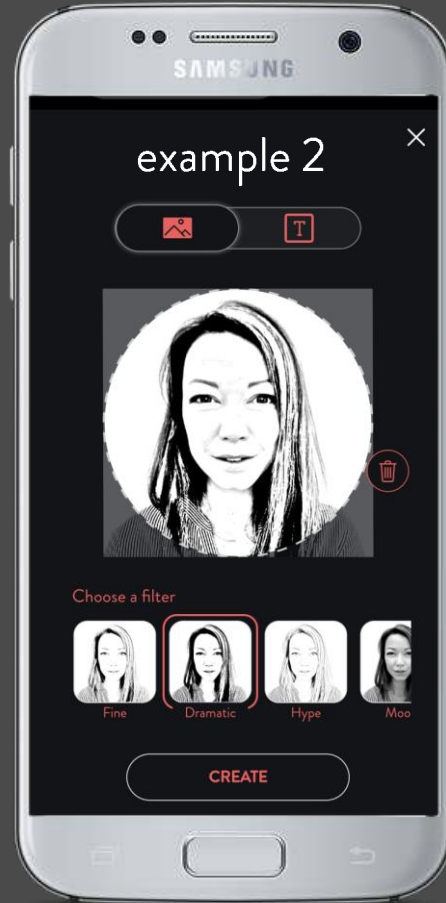
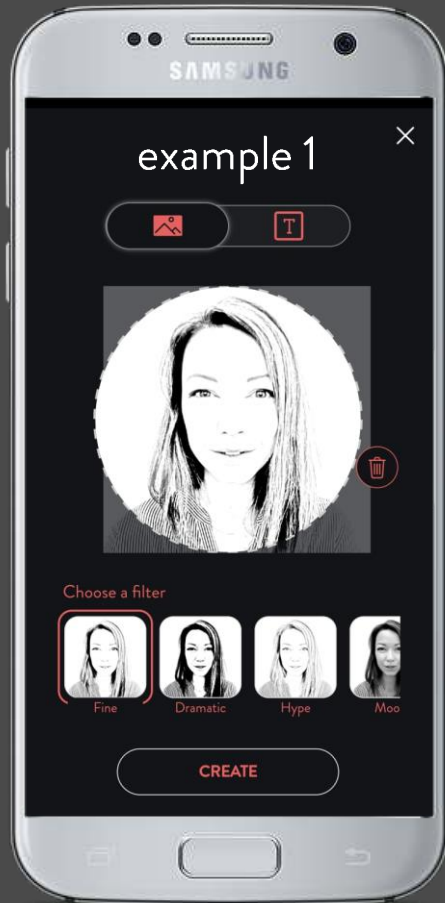

This filter is great, eyes and hair are defined, background is bright and white. A white background free of distractions/objects always looks better than a dark background when printed.

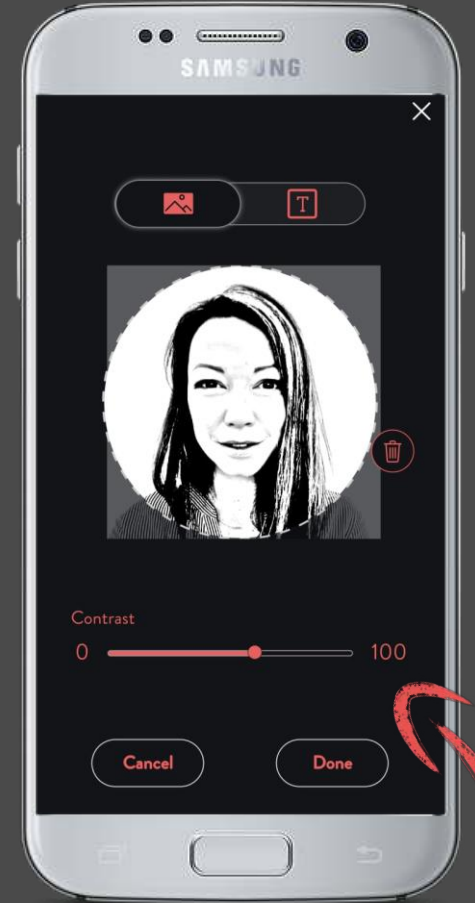

1. Select a photograph from your phone's library, or take a new one with the camera.
2. Choose a filter that enhances the contrast of the image, some filters will help brighten the image like "fine", see example 1, others will help intensify the contrast, like the "Dramatic" filter, see example 2. Tap the filter after selecting it to adjust the intensity.
3. Tap "CREATE" and follow the steps on slide 5 & 6.

CREATE

Add text to an image or create a text only design!



Tap the “T” to add a text to your image.

Select from different fonts, tap the alignment tool to view different layouts, and choose text color.

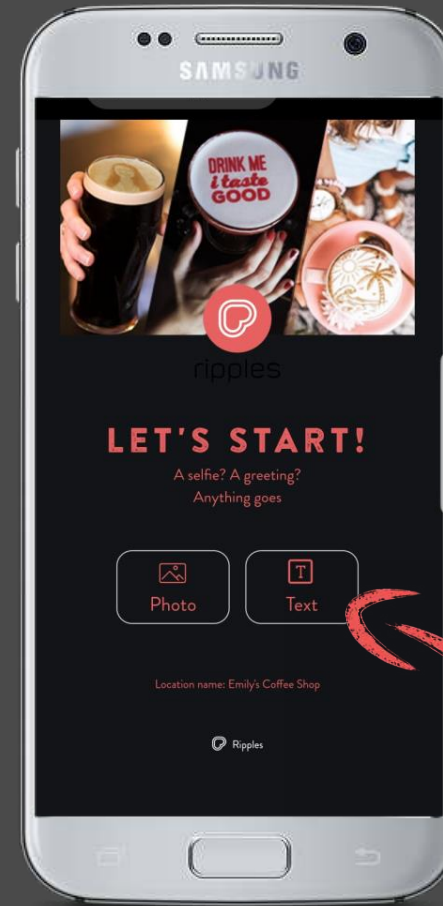

1. Tap “Text” to start

2. Write your custom message and choose a font, tap the alignment button to try out different alignments. When ready tap “CREATE” and follow the steps slide 5 & 6.

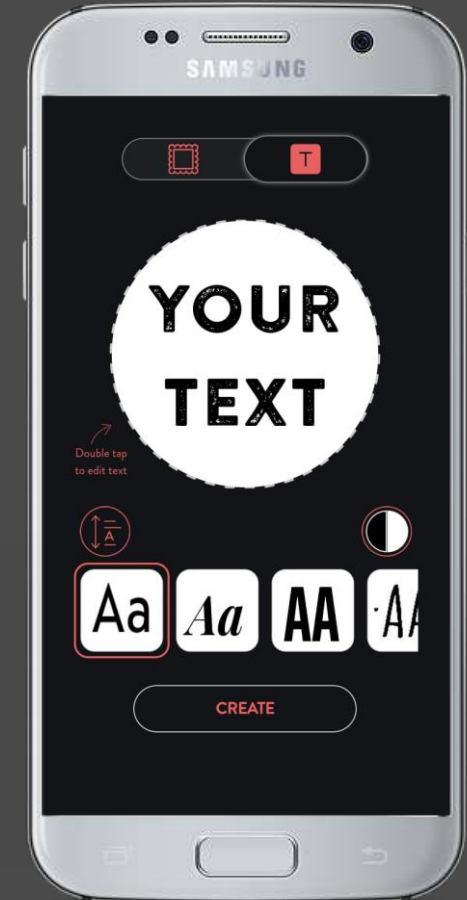

DELETE

This feature allows you to delete designs off of your Ripple Maker!

1. Select the designs you wish to remove and tap DELETE



2. Confirm that you want these designs removed. They will delete it from any Ripple Makers at your location.

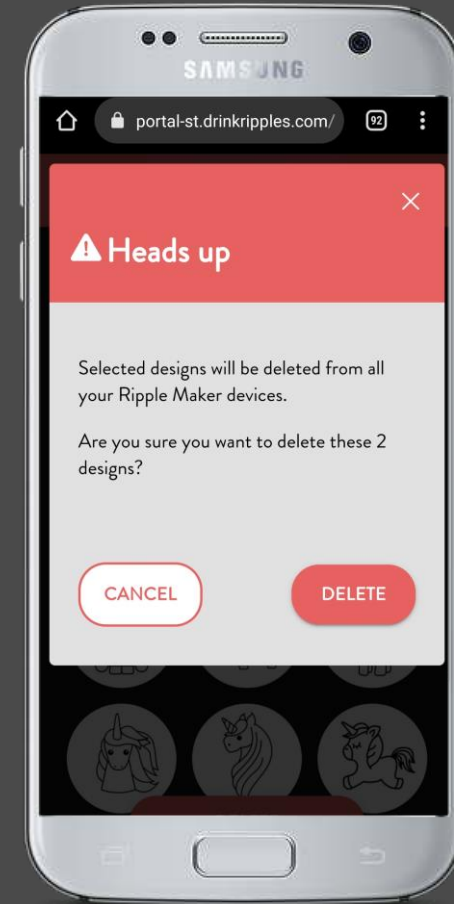

PUBLISH

This feature allows you to search 1000s of tagged designs in the Ripples Library and add them to your Ripple Maker or Ripples Web App!

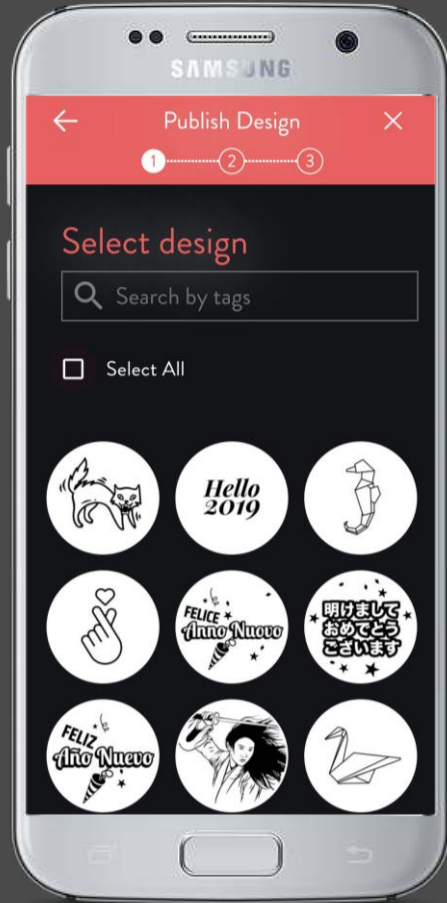

1. Search using tags, select one, many or all

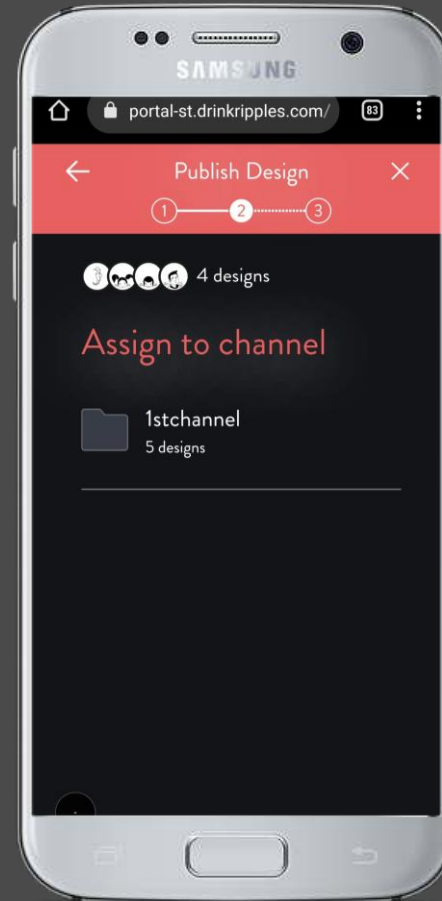

2. Select where you would like this design available. On The Ripples Web App and/or on your Ripple Maker

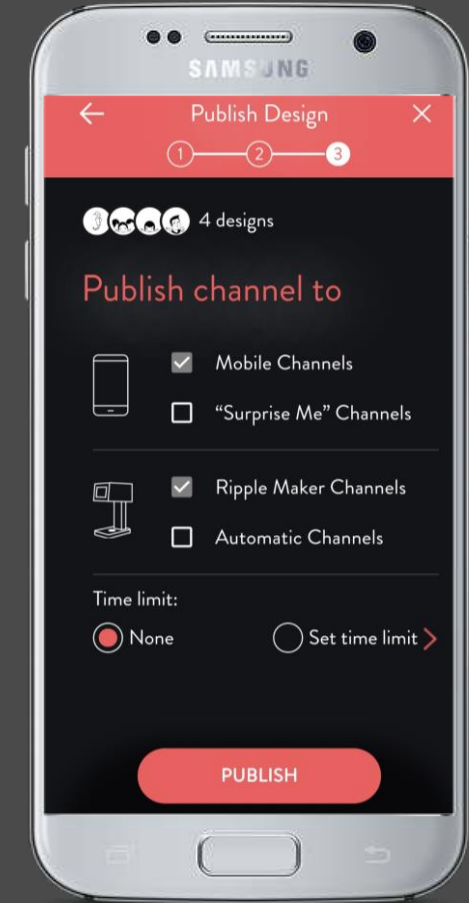

3. Set a time limit and tap "PUBLISH" to upload

FRAMES

This feature allows you to search unique frames from the Ripples Library!
Frames are added to photos sent through the Ripples Web App

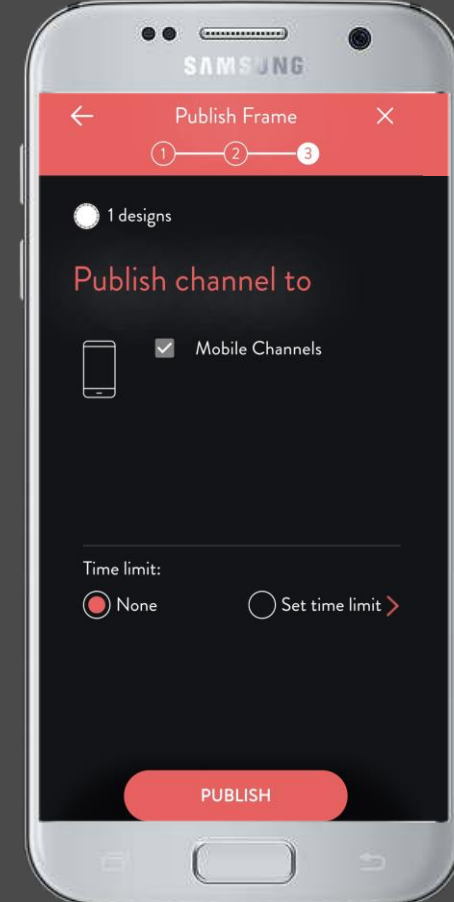
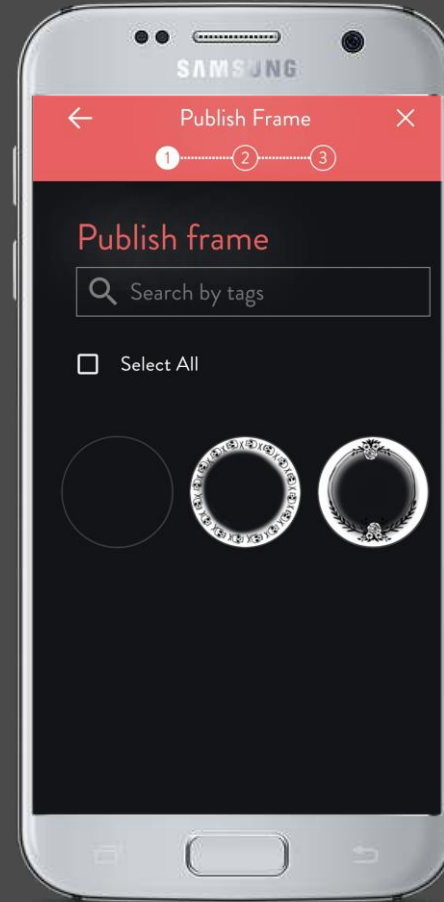
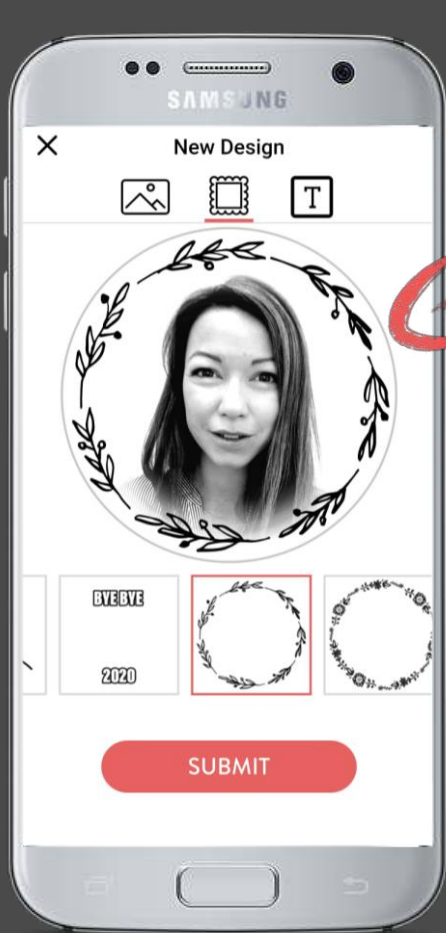

1. Select the frames you wish to add
2. Select a time limit
3. Tap “PUBLISH” to add the new frames to the Ripples WebApp

QR CODE

Download your Ripples Web App, printable QR Code, or link!

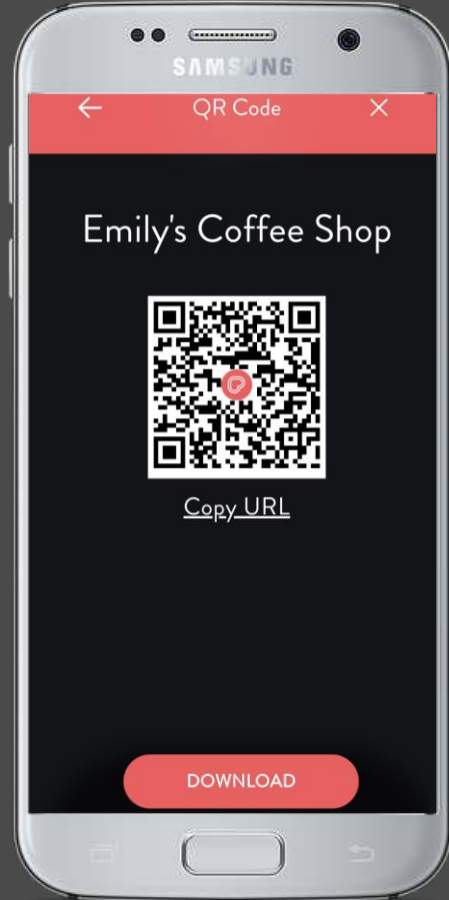

1. Download the QR Code or copy the URL
2. Use the QR code on posters around your location to encourage your guests to send images of their own to the Ripple Maker!
3. Scan the QR Code or use the link to send images through the Ripples Web App.

HELP

If you need some guidance.

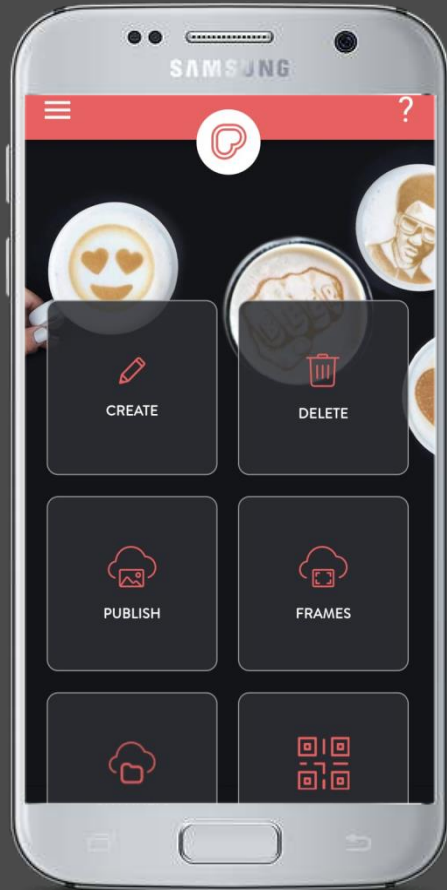

1. Tap the “?” in the top right corner for help.
2. Or reach out to our Care Center at support@drinkripples.com for more help.

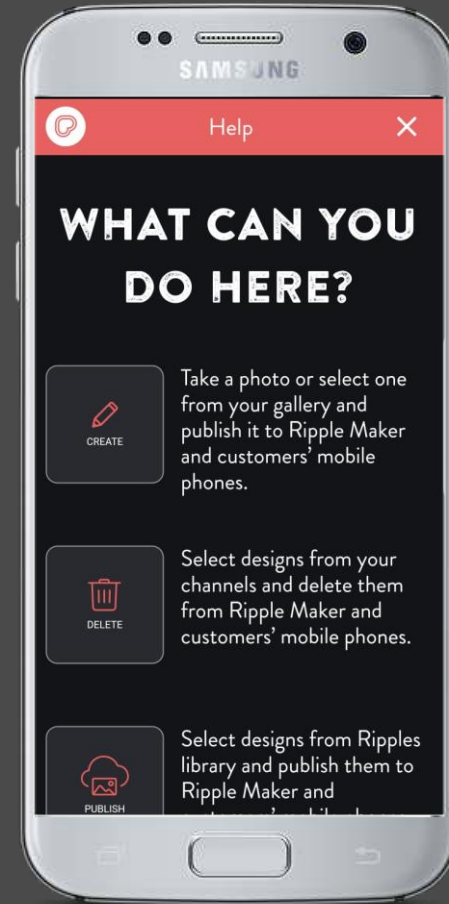

FAQS

How do I get back to the web app?

Tap the 3 lines in the top left corner and tap Ripples Web App to return to the Web App.

How can I see what designs are on my Ripple Maker or Web App?

Tap “Delete” and you will be able to see all the designed published to your Ripple Maker and Mobile App.

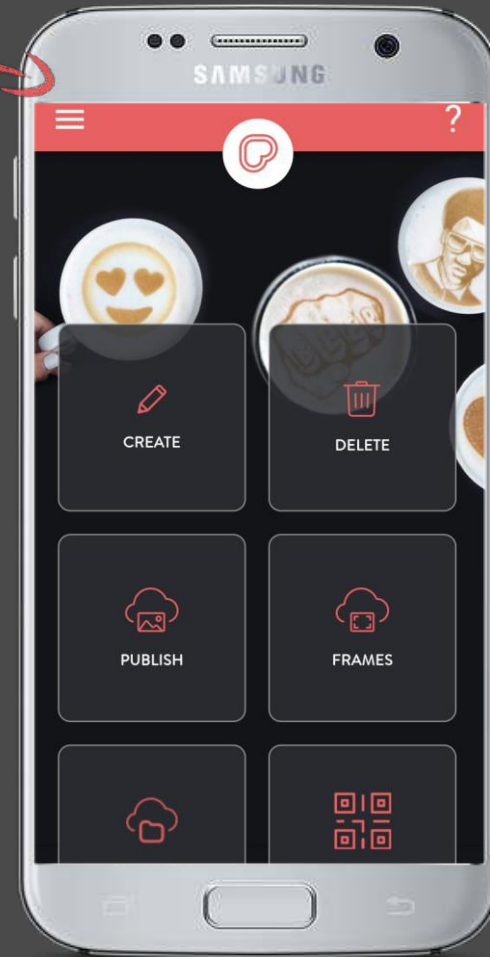

Can I access the Ripples Cloud from my PC?

Yes, you can use this link to access the Ripples Cloud on your PC.

<https://my.drinkripples.com/>

Can I create my own custom channels in the Ripples Mobile Cloud?

No, you can make new custom channels through the PC version of the Cloud.

Do I need a different user for the PC version of the Ripples Cloud?

No, you can use the same user login details for both.



THANK
YOU

